

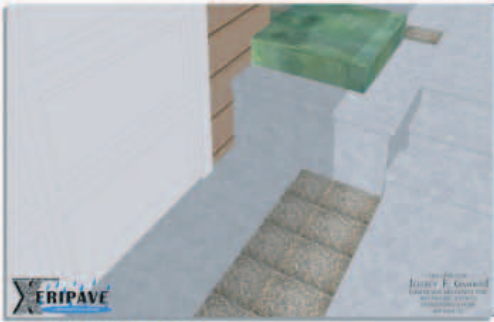

DOG RUN

Water stations at dog parks are a perfect spot for Xeripave Super Permeous Pavers replacing the usual muddy mess with a clean surface. Also, dog runs paved with Xeripave Super Permeous Pavers allow for easy cleanup and wash down without the required removal of the contaminated aggregate.



DRIVEWAY DRAIN

A step of Xeripave Super Permeous Pavers at the bottom of a sloped driveway intercepts water away from the garage. The captured water can be diverted to an appropriate location. Strategically placed it can capture storm water prior to discharge onto a street or into a storm drain system.

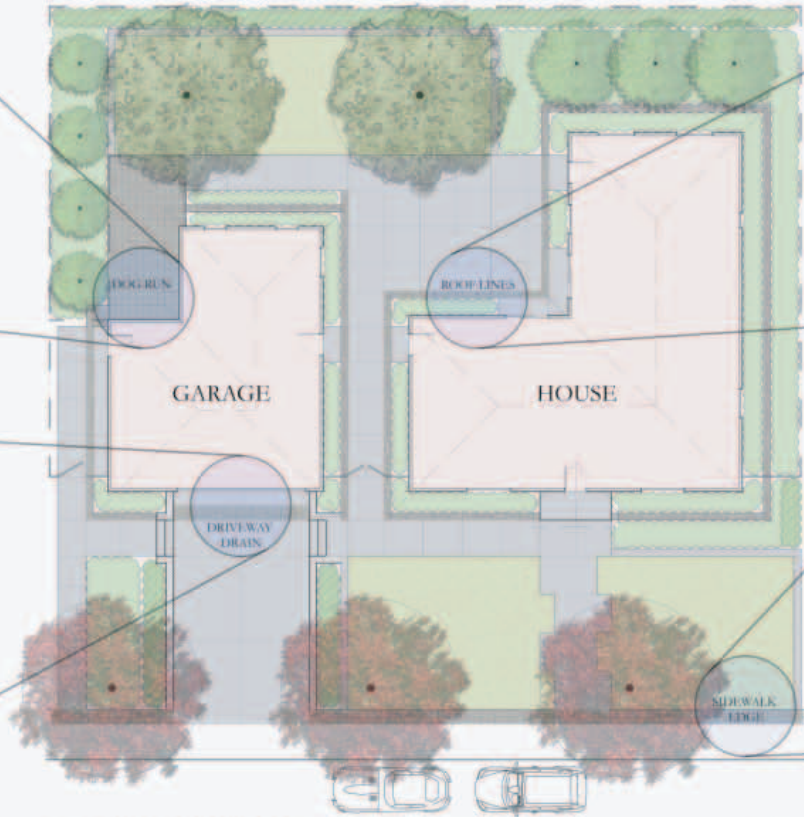

ROOF LINES

Xeripave Super Permeous Pavers provide a hard but permeable surface that will prevent soil erosion under roof eaves or at downspouts by slowing and spreading the flow of water. At the building edge a strip of pavers provides a clean border at the foundation, underneath which different methods of containment or reduction of water are employed.

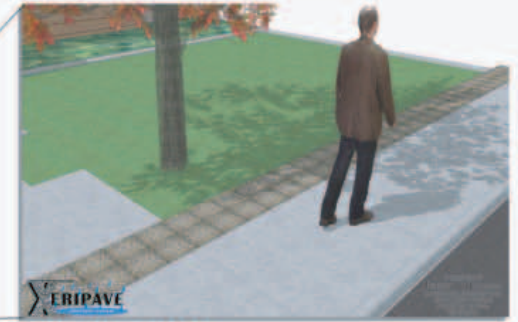

SIDEWALK EDGE

A 24" Xeripave Super Permeous Paver border at the edge of sidewalk which separates the planting from the hardscape eliminates the need for sprinklers along the sidewalk thus reducing the possibility of irrigation runoff. This 24" zone free of overhead irrigation is a requirement of the Water Efficient Landscape Ordinance (AE 1881).



RESIDENTIAL APPLICATIONS

THE OFFICE OF
JEFFREY F. GAMBONI
LANDSCAPE ARCHITECT 2702
3012 PACIFIC AVENUE
STOCKTON 95204
209 948 8335